

**Department of Public Safety  
Division**



**Liquor Licensing & Inspection**

Promise by any person that he or she can expedite a liquor license through influence should be completely disregarded. To avoid possible financial loss an applicant, or prospective applicant, should consult with the Division before making any substantial investment in an establishment that now is, or may be, attended by a liquor license.

<b>BUREAU USE ONLY</b>	
License No. Assigned:	
Class:	
Deposit Date:	
Amt. Deposited:	

**PRESENT LICENSE EXPIRES** 06/02/2014

**INDICATE TYPE OF PRIVILEGE:**  MALT  SPIRITUOUS  VINOUS

**INDICATE TYPE OF LICENSE:**

- RESTAURANT (Class I,II,III,IV)
- HOTEL-OPTIONAL FOOD (Class I-A)
- CLASS A LOUNGE (Class X)
- CLUB (Class V)
- TAVERN (Class IV)

- RESTAURANT/LOUNGE (Class XI)
- HOTEL (Class I,II,III,IV)
- CLUB-ON PREMISE CATERING (Class I)
- GOLF CLUB (Class I,II,III,IV)
- OTHER: \_\_\_\_\_

**REFER TO PAGE 3 FOR FEE SCHEDULE**

**ALL QUESTIONS MUST BE ANSWERED IN FULL**

<b>1. APPLICANT(S)</b> —(Sole Proprietor, Corporation, Limited Liability Co., etc.) <u>Inn by the Sea LLC</u> DOB:	<b>2. Business Name (D/B/A)</b>
DOB:	
DOB:	<b>Location (Street Address)</b> <u>40 Bowery Beach Rd</u>
<b>Address</b> <u>40 Bowery Beach Rd</u>	<b>City/Town</b> <u>Cape Elizabeth</u> <b>State</b> <u>ME</u> <b>Zip Code</b> <u>04107</u>
	<b>Mailing Address</b>
<b>City/Town</b> <u>Cape Elizabeth</u> <b>State</b> <u>ME</u> <b>Zip Code</b> <u>04107</u>	<b>City/Town</b> _____ <b>State</b> _____ <b>Zip Code</b> _____
<b>Telephone Number</b> <u>207-799-3134</u> <b>Fax Number</b> <u>207-799-4779</u>	<b>Business Telephone Number</b> _____ <b>Fax Number</b> _____
<b>Federal I.D. #</b> <u>20-834998</u>	<b>Seller Certificate #</b> <u>1097910</u>

- 3. If premises are a hotel, indicate number of rooms available for transient guests: 61
- 4. State amount of gross income from period of last license: ROOMS \$5,373,273 FOOD \$1,461,296 LIQUOR \$521,164
- 5. Is applicant a corporation, limited liability company or limited partnership? YES  NO

complete Supplementary Questionnaire ,If YES

- 6. Do you permit dancing or entertainment on the licensed premises? YES  NO
- 7. If manager is to be employed, give name: Sara C. Masterson
- 8. If business is NEW or under new ownership, indicate starting date: \_\_\_\_\_  
Requested inspection date: \_\_\_\_\_ Business hours: \_\_\_\_\_
- 9. Business records are located at: 40 Bowery Beach Rd Cape Elizabeth ME 04107
- 10. Is/are applicants(s) citizens of the United States? YES  NO

11. Is/are applicant(s) residents of the State of Maine? YES  NO

12. List name, date of birth, and place of birth for all applicants, managers, and bar managers. Give maiden name, if married: Use a separate sheet of paper if necessary.

Name in Full (Print Clearly)	DOB	Place of Birth
Kevin Mahaney		Bangor ME
Sara Masterson		Newton MA

Residence address on all of the above for previous 5 years (Limit answer to city & state)

Kevin Mahaney 90 Bawery Beach Road Cape Elizabeth, ME 04107

Sara Masterson 18 Old Colony Lane Scarborough, ME 04107

13. Has/have applicant(s) or manager ever been convicted of any violation of the law, other than minor traffic violations, of any State of the United States? YES  NO

Name: \_\_\_\_\_ Date of Conviction: \_\_\_\_\_

Offense: \_\_\_\_\_ Location: \_\_\_\_\_

Disposition: \_\_\_\_\_

14. Will any law enforcement official benefit financially either directly or indirectly in your license, if issued? Yes  No  If Yes, give name: \_\_\_\_\_

15. Has/have applicant(s) formerly held a Maine liquor license? YES  NO

16. Does/do applicant(s) own the premises? Yes  No  If No give name and address of owner: \_\_\_\_\_

17. Describe in detail the premises to be licensed: (Supplemental Diagram Required) Hotel with 61 guest rooms, 48 seat restaurant, lounge & meeting space

18. Does/do applicant(s) have all the necessary permits required by the State Department of Human Services? YES  NO  Applied for: \_\_\_\_\_

19. What is the distance from the premises to the NEAREST school, school dormitory, church, chapel or parish house, measured from the main entrance of the premises to the main entrance of the school, school dormitory, church, chapel or parish house by the ordinary course of travel? 1/2 mile Which of the above is nearest? Church

20. Have you received any assistance financially or otherwise (including any mortgages) from any source other than yourself in the establishment of your business? YES  NO   
If YES, give details: Bangor Savings Bank - mortgage

The Division of Liquor Licensing & Inspection is hereby authorized to obtain and examine all books, records and tax returns pertaining to the business, for which this liquor license is requested, and also such books, records and returns during the year in which any liquor license is in effect.

NOTE: "I understand that false statements made on this form are punishable by law. Knowingly supplying false information on this form is a Class D offense under the Criminal Code, punishable by confinement of up to one year or by monetary fine of up to \$2,000 or both."

Dated at: Cape Elizabeth, ME on April 8, 2014

Town/City, State

Date

Please sign in blue ink

Signature of Applicant or Corporate Officer(s)

Signature of Applicant or Corporate Officer(s)

STATE OF MAINE  
**Liquor Licensing & Inspection Unit**  
 164 State House Station  
 Augusta, Maine 04333-0164  
 Tel: (207) 624-7220 Fax: (207) 287-3424

**SUPPLEMENTARY QUESTIONNAIRE FOR CORPORATE APPLICANTS, LIMITED LIABILITY COMPANIES AND LIMITED PARTNERSHIPS**

1. Exact Corporate Name: Inn by the Sea, LLC

Business D/B/A Name: \_\_\_\_\_

2. Date of Incorporation: 01/03/2007

3. State in which you are incorporated: Delaware

4. If not a Maine Corporation, date corporation was authorized to transact business within the State of Maine:  
01/03/2007

5. List the name and addresses for previous 5 years, birth dates, titles of officers, directors and list percent of stock owned:

Name	Address Previous 5 Years	Birth Date	% of Stock	Title
Kevin Mahaney	30 Oneida Rd Greenwich CT		69	CEO
Peter Alford	250 Bradley Place Palm Beach, FL		30	
Greg Powell	2 Golden Ridge Cape Elizabeth ME		1	

6. What is the amount of authorized stock? 100 Outstanding Stock? 100

7. Is any principal officer of the corporation a law enforcement official? ( ) YES (  ) NO

8. Has applicant(s) or manager ever been convicted of any violation of the law, other than a minor traffic violation(s), of the United States? ( ) YES (  ) NO.

9. If yes, please complete the following: Name: \_\_\_\_\_

Date of Conviction: \_\_\_\_\_ Offense: \_\_\_\_\_

Location: \_\_\_\_\_ Disposition: \_\_\_\_\_

Dated at: Cape Elizabeth On: 4/8/14  
City/Town Date

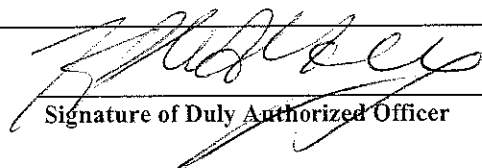

Date: 04/08/2014

\_\_\_\_\_  
 Print Name of Duly Authorized Officer

STATE OF MAINE

Dated at: \_\_\_\_\_, Maine \_\_\_\_\_ ss  
City/Town (County)

On: \_\_\_\_\_  
Date

The undersigned being: \_\_\_\_\_ Municipal Officers \_\_\_\_\_ County Commissioners of the  
\_\_\_\_\_ City \_\_\_\_\_ Town \_\_\_\_\_ Plantation \_\_\_\_\_ Unincorporated Place of: \_\_\_\_\_, Maine

Hereby certify that we have given public notice on this application and held public hearing thereon as required by Section 653 Title 28A, Maine Revised Statutes and herby approve said application.

\_\_\_\_\_  
\_\_\_\_\_

THIS APPROVAL EXPIRES IN 60 DAYS

NOTICE – SPECIAL ATTENTION

§ 653. Hearings; bureau review; appeal

1. **Hearing.** The municipal officers or, in the case of unincorporated places, the county commissioners of the county in which the unincorporated place is located, shall hold a public hearing for the consideration of applications for new on-premise licenses and applications for transfer of location of existing on-premise licenses. The municipal officers or county commissioners may hold a public hearing for the consideration of requests for renewal of licenses, except that when an applicant has held a license for the prior 5 years and a complaint has not been filed against the applicant within that time, the applicant may request a waiver of the hearing.
    - A. The bureau shall prepare and supply application forms. [1993, c.730, §27(amd).]
    - B. The municipal officers or the county commissioners, as the case may be, shall provide public notice of any hearing held under this section by causing a notice, at the applicant's prepaid expense, stating the name and place of hearing, to appear on at least 3 consecutive days before the date of hearing in a daily newspaper having general circulation in the municipality where the premises are located or one week before the date of the hearing in a weekly newspaper having general circulation in the municipality where the premises are located. [1995, c.140, §4 (amd).]
    - C. If the municipal officers or the county commissioners, as the case may be, fail to take final action on an application for a new on-premise license, for transfer of the location of an existing on-premise license or for renewal of an on-premise license within 60 days of the filing of an application, the application is deemed approved and ready for action by the bureau. For purposes of this paragraph, the date of filing of the application is the date the application is received by the municipal officers or county commissioners. This paragraph applies to all applications pending before municipal officers or county commissioners as of the effective date of this paragraph as well as all applications filed on or after the effective date of this paragraph. This paragraph applies to an existing on-premise license that has been extended pending renewal. The municipal officers or the county commissioners shall take final action on an on-premise license that has been extended pending renewal with 120 days of the filing of the application. [1999, c589, §1 (amd).]
  2. **Findings.** In granting or denying an application, the municipal officers or the county commissioners shall indicate the reasons for their decision and provide a copy to the applicant. A license may be denied on one or more of the following grounds:
    - A. Conviction of the applicant of any Class A, Class B or Class c crime: [1987, c45, Pt.A§4 (new).]
    - B. Noncompliance of the licensed premises or its use with any local zoning ordinance or other land use ordinance not directly related to liquor control; [1987, c.45, Pt.A§4(new).]
    - C. Conditions of record such as waste disposal violations, health or safety violation or repeated parking or traffic violations on or in the vicinity of the licensed premises and caused by persons patronizing or employed by the licensed premises or other such conditions caused by persons patronizing or employed by the licensed premises that unreasonably disturb, interfere with or affect the ability of persons or businesses residing or located in the vicinity of the licensed premises to use their property in a reasonable manner; [1993, c.730, §27 (amd).]
    - D. Repeated incidents of record of breaches of the peace, disorderly conduct, vandalism or other violations of law on or in the vicinity of the licensed premises and caused by persons patronizing or employed by the licensed premises; [1989, c.592,§3 (amd).]
    - E. A violation of any provision of this Title; and [1989, c.592, §3 (amd).]
    - F. A determination by the municipal officers or county commissioners that the purpose of the application is to circumvent the provisions of section 601. [1989, c.592, §4 (new).]
- [1993, c730, §27 (amd).]
3. **Appeal to bureau.** Any applicant aggrieved by the decision of the municipal officers or county commissioners under this section may appeal to the bureau within 15 days of the receipt of the written decision of the municipal officers or county commissioners. The bureau shall hold a public hearing in the city, town or unincorporated place where the premises are situated. In acting on such an appeal, the bureau may consider all licensure requirements and findings referred to in subsection 2.
    - A. [1993, c.730, §27 (rp).]
  4. **No license to person who moved to obtain a license. (REPEALED)**
  5. **(TEXT EFFECTIVE 3/15/01) Appeal to District Court.** Any person or governmental entity aggrieved by a bureau decision under this section may appeal the decision to the District Court within 30 days of receUpon resolution of the appeal, if an applicant's license renewal is denied, the bureau shall refund the applicant the prorated amount of the unused license fee.



pd \$10.00 4/9/2014  
ck # 022664

Town Clerk's Office  
P.O. Box 6260  
Cape Elizabeth, Maine 04107  
799-7665

**APPLICATION FOR SPECIAL AMUSEMENT PERMIT FOR  
DANCING AND ENTERTAINMENT**  
*A \$10.00 fee must accompany the completed application.*

BUSINESS NAME Inn by the Sea, LLC  
ADDRESS 40 Bowery Beach Rd  
Cape Elizabeth ME 04107

Describe in detail the kind and nature of entertainment:  
DJ for outdoor events, piano, jazz, classical, guitar, flute  
harp and classical string

Describe in detail the room or rooms that will be used under this permit:  
\_\_\_\_\_

Dated at Cape Elizabeth ME On April 8 20 14

This permit includes all types of entertainment, dancing is inclusive only if you have a dancing license issued by the State Fire Marshall's Office, Department of Public Safety.

[Signature]  
Signature of Individual \_\_\_\_\_ If partnership, by members \_\_\_\_\_

\_\_\_\_\_  
Name of Corporation \_\_\_\_\_ PLACE CORPORATE SEAL

By \_\_\_\_\_  
If a Corporation, by a duly authorized officer

STATE OF MAINE

\_\_\_\_\_ ss  
Dated at \_\_\_\_\_, Maine On \_\_\_\_\_ 20 \_\_\_\_

The undersigned being Municipal Officers of the Town of Cape Elizabeth hereby approve the application in accordance with the provisions of Section, 702 of Title 28, Maine Revised Statutes, 1964.

\_\_\_\_\_  
\_\_\_\_\_  
\_\_\_\_\_



## SUPPLEMENTAL APPLICATION FORM ON-PREMISE DIAGRAM

In an effort to clearly define your license premise and the areas that consumption and storage of liquor is allowed, The Liquor Licensing & Inspection Division is requiring all applicants to submit a diagram of the premise to be licensed in addition to a completed license application.

Diagrams should be submitted on this form and should be as accurate as possible. Be sure to label the areas of your diagram including entrances, office area, kitchen, storage areas, dining rooms, lounges, function rooms, decks and all areas that you are requesting approval from the Department for liquor consumption.

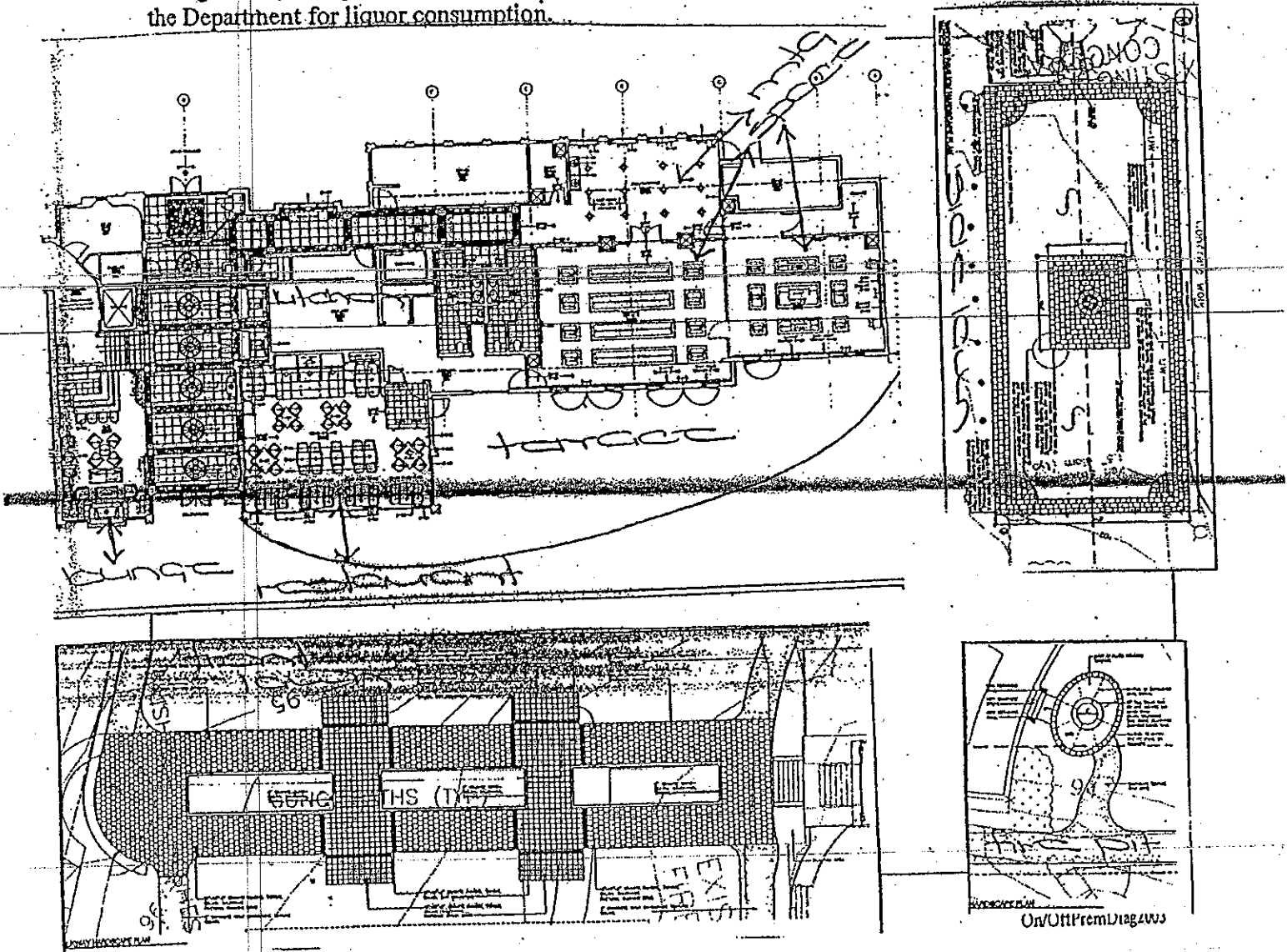

On/PremDiagram

# PREMISE DIAGRAM

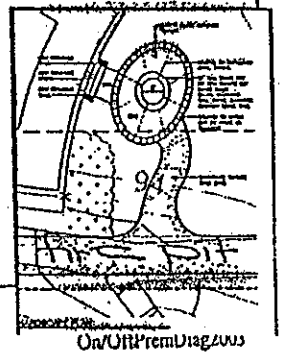
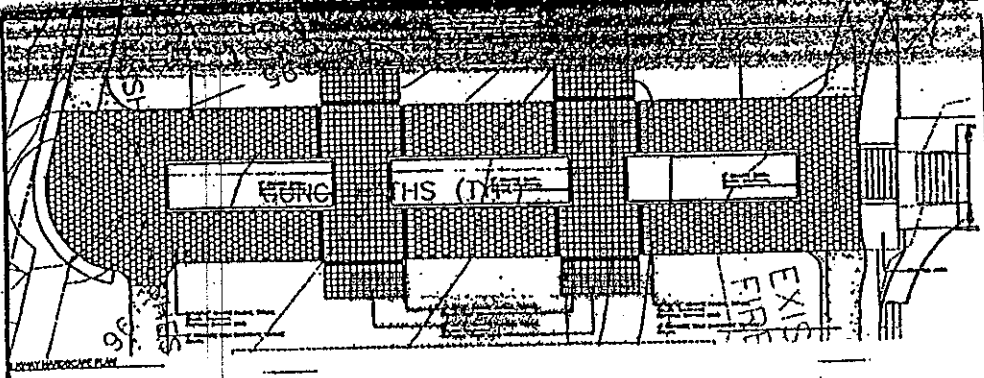
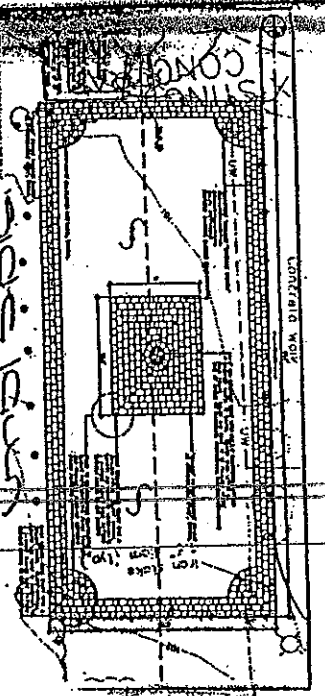
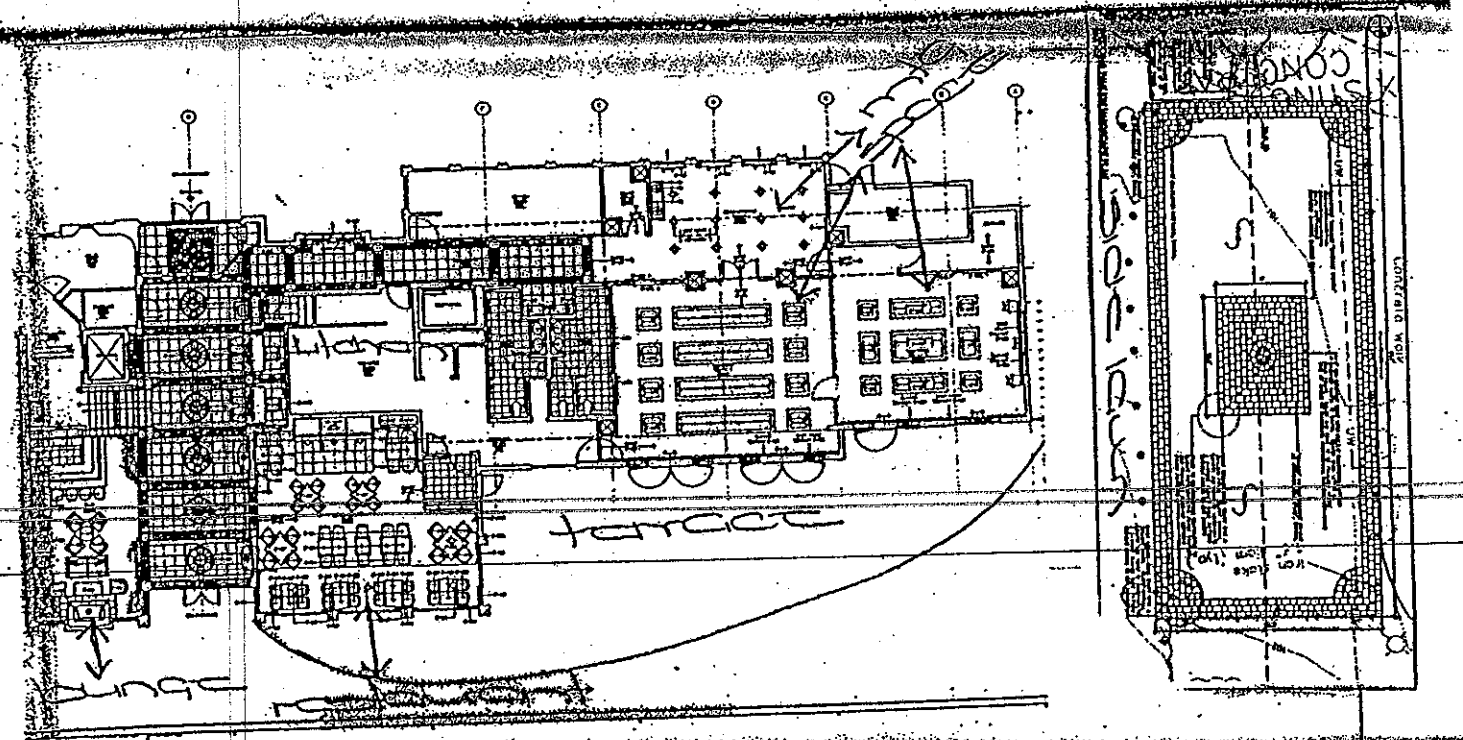

On/ORPremDiag2003



NO. 100	DATE	BY	CHECKED
100	10/10/00	J.M.	J.M.
101	10/10/00	J.M.	J.M.
102	10/10/00	J.M.	J.M.
103	10/10/00	J.M.	J.M.
104	10/10/00	J.M.	J.M.
105	10/10/00	J.M.	J.M.
106	10/10/00	J.M.	J.M.
107	10/10/00	J.M.	J.M.
108	10/10/00	J.M.	J.M.
109	10/10/00	J.M.	J.M.
110	10/10/00	J.M.	J.M.
111	10/10/00	J.M.	J.M.
112	10/10/00	J.M.	J.M.
113	10/10/00	J.M.	J.M.
114	10/10/00	J.M.	J.M.
115	10/10/00	J.M.	J.M.
116	10/10/00	J.M.	J.M.
117	10/10/00	J.M.	J.M.
118	10/10/00	J.M.	J.M.
119	10/10/00	J.M.	J.M.
120	10/10/00	J.M.	J.M.

ISSUED BY THE AREA  
MANAGER  
DATE: 10/10/00  
PROJECT: MONCOUR  
DRAWING NO. 100  
SCALE: AS SHOWN  
SHEET NO. 1 OF 1

MAIN LOBBY & MEETING  
ROOMS  
FURNITURE PLAN

ID: 5

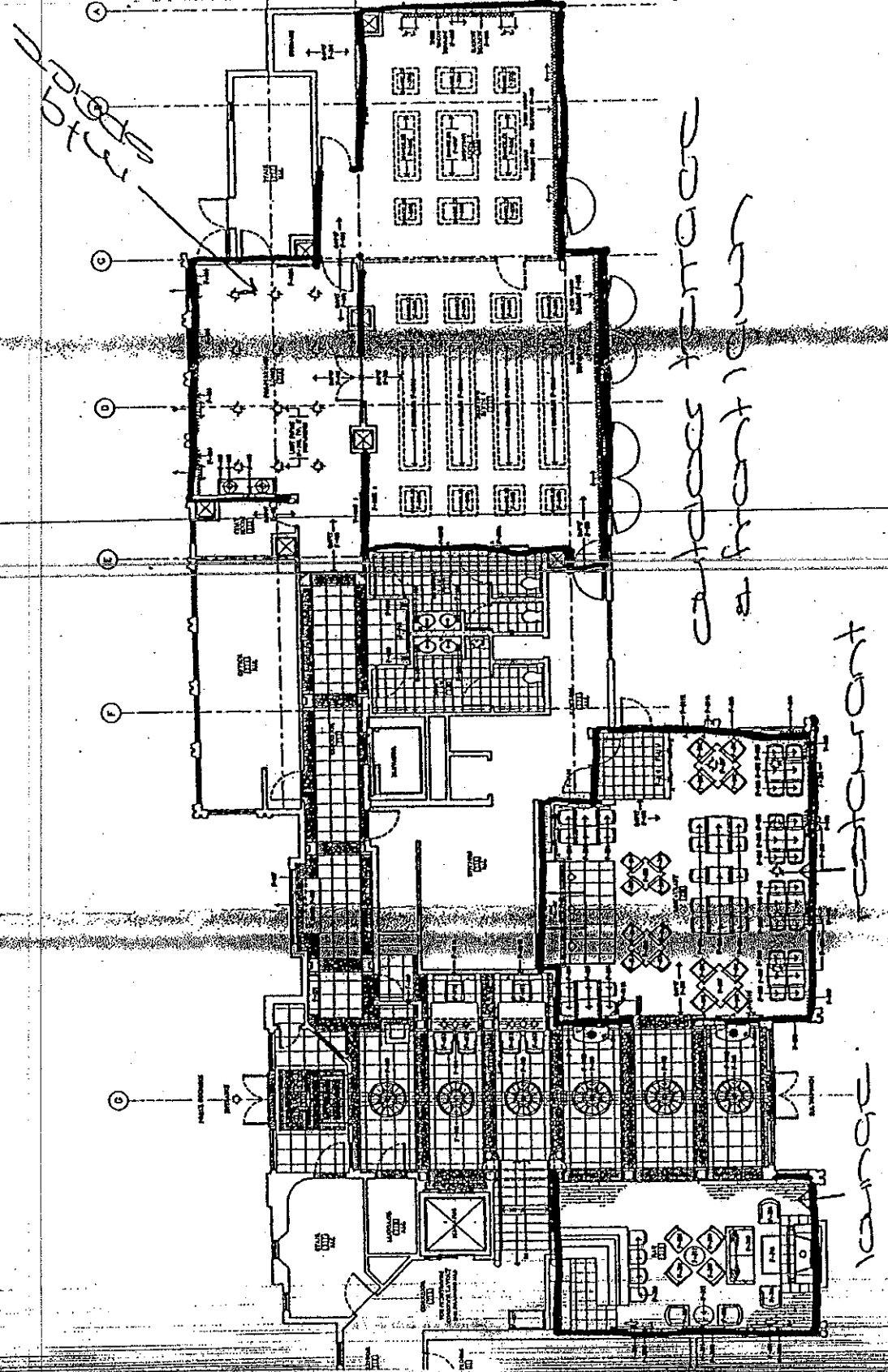

Lobby + Meeting

UP

DOWN



TH PROPOSED 40 BOWERY M

OLYMPIA  
 SCHEIDT ENGINEERING  
 INN BY THE SEA LLC,  
 SUITE 202  
 200 FORE STREET  
 PORTLAND, ME 0410  
 T(207) 874-9900

TPH ARCHITECTS  
 100 COMMERCIAL STREET  
 PORTLAND MAINE 04101  
 TELEPHONE 207 778 8141  
 ARCHITECTURE PLANNING  
 CONSULTANTS

ARCHITECTURE PLANNING  
 CONSULTANTS  
 100 COMMERCIAL STREET  
 PORTLAND MAINE 04101  
 TELEPHONE 207 778 8141

REVISIONS:	NO. 44-07 CLERT REVIEW
DATE:	04.28.07
PROJECT NO.:	07006
DRAWN BY:	JAK
CHECKED BY:	BJE
SCALE:	AS NOTED
SHEET TITLE:	

SITE  
 DETAILS

C-103

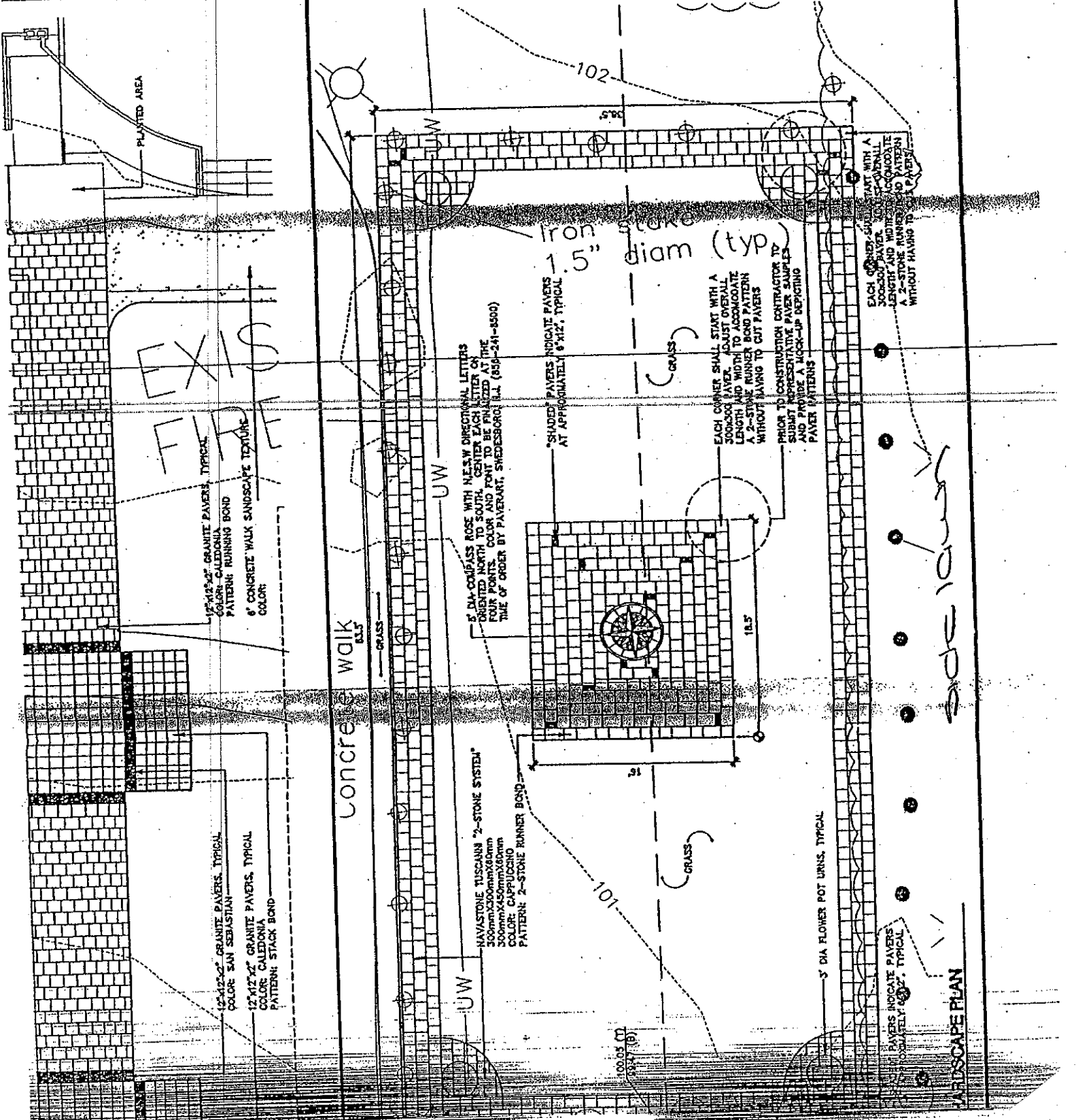

PLAYED AREA

12x12x2" GRANITE PAVERS, TYPICAL  
 COLOR: CALEDONIA  
 PATTERN: RUNNING BOND

6" CONCRETE WALK SANDSCAPE TEXTURE  
 COLOR:

12x12x2" GRANITE PAVERS, TYPICAL  
 COLOR: SAN SEBASTIAN  
 PATTERN: STACK BOND

12x12x2" GRANITE PAVERS, TYPICAL  
 COLOR: CALEDONIA  
 PATTERN: STACK BOND

Concrete walk

5" DIA COMPASS ROSE WITH N-E-S-W DIRECTIONAL LETTERS  
 ORIENTED NORTH TO SOUTH CENTER EACH LETTER ON  
 FOUR POINTS. COURTESY POINT TO BE FINISHED AT THE  
 TIME OF ORDER BY PAVERART, SHEDDERSBORO, N.J. (856-241-8500)

NAVASTONE TUSCANY "2-STONE SYSTEM"  
 300mm x 300mm x 40mm  
 COLOR: CALPELUCINO  
 PATTERN: 2-STONE RUNNER BOND

Iron stake  
 1.5" diam (typ)

"SHADED PAVERS INDICATE PAVERS  
 AT APPROXIMATELY 6"x12", TYPICAL

EACH CORNER SHALL START WITH A  
 300x300 PAVES. ADJUST OVERALL  
 LENGTH AND WIDTH TO ACCOMMODATE  
 A 2-STONE RUNNER BOND PATTERN  
 WITHOUT HAVING TO CUT PAVERS

PRIOR TO CONSTRUCTION CONTRACTOR TO  
 SUBMIT REPRESENTATIVE PAVES SAMPLES  
 AND PROVIDE A MOCK-UP DEPICTING  
 PAVES PATTERNS

EACH CORNER SHALL START WITH A  
 300x300 PAVES. ADJUST OVERALL  
 LENGTH AND WIDTH TO ACCOMMODATE  
 A 2-STONE RUNNER BOND PATTERN  
 WITHOUT HAVING TO CUT PAVERS

3" DIA FLOWER POT URNS, TYPICAL

PAVERS INDICATE PAVERS  
 SAMPLES TO BE SUBMITTED

LANDSCAPE PLAN

side lawn

LONGER

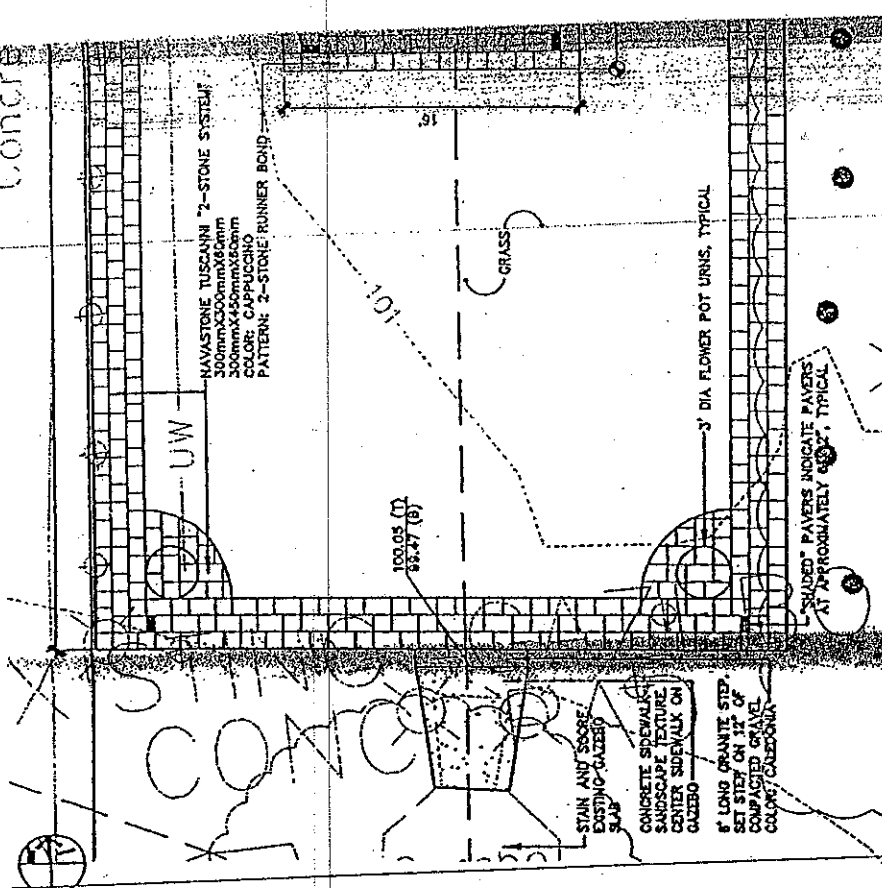

WEDDING PAVILION HARDSCAPE PLAN

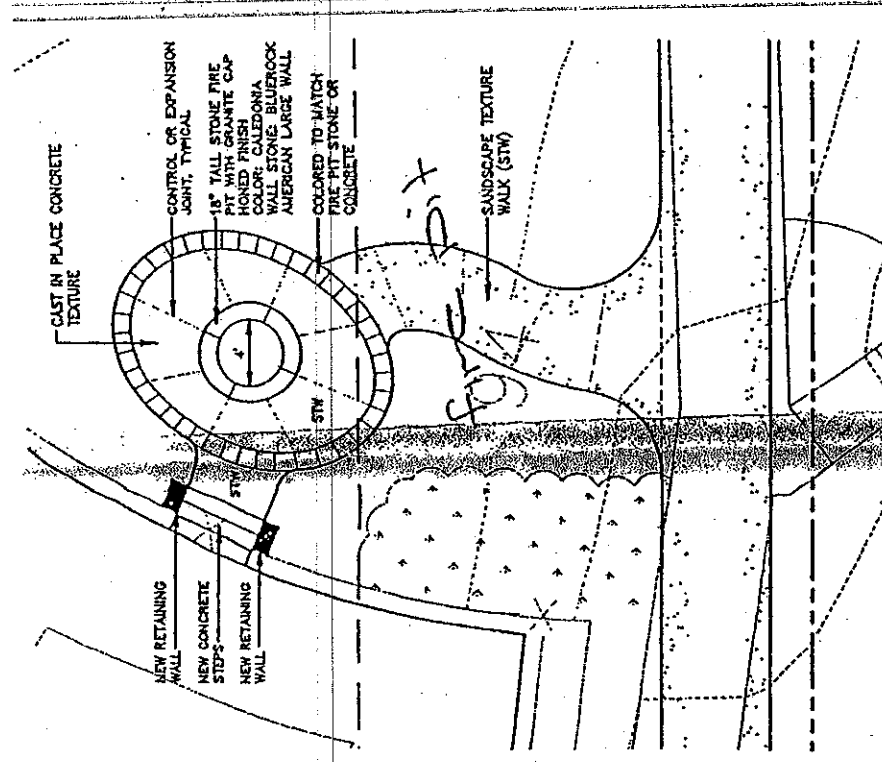

HARDSCAPE PLAN

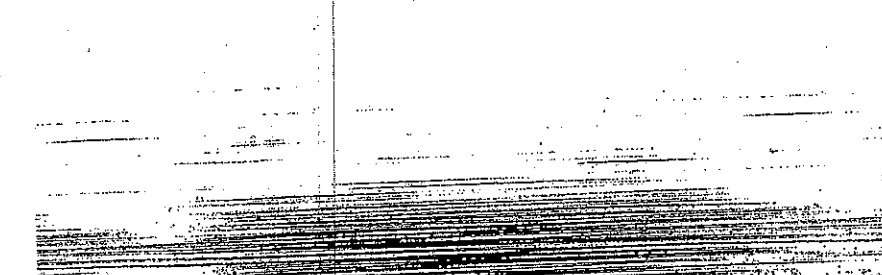

COURTY